



TAUCH
TERMINAL
LIVEBOARD



TAUCH
TERMINAL
B A L I



TAUCH
TERMINAL
RESORT TULAMBEN



Mermaid 1 here in front of our Tauch Terminal Resort Tulamben

Mermaid 1 was built 2001 in Thailand. Now she has two seasons behind her. With some minor improvements she will start her duty in May 2003 with a new and very flexible schedule, which will bring you to the best dive spots between Bali and Komodo.

MERMAID I SAFARI 6 DAYS AND 7 NIGHTS
Bali – Komodo or Komodo – Bali

and optional
6 DAYS / 5 NIGHTS At TAUCH TERMINAL RESORT TULAMBEN

<u>DAYS</u>	<u>DESCRIPTIONS</u>	<u>DIVES</u>
FRIDAY	<p>Check-in on board of the Mermaid I approximately 4.p.m rite in front of our dive resort in Tulamben. Later after checking equipment and first briefings, dinner will be served on board and we will cruise overnight to Moyo Island.</p>	
SATURDAY	<p>Your first day of diving will be around Moyo and Satonda, where we will have 4 dives. Two at Moyo then we proceed to Satonda where we have one day and one night dive. After dinner we cruise to Gili Banta Island.</p>	4
SUNDAY	<p>The morning, which everyone is waiting for, we will check in at the Komodo National park and combine that with a walk to the Dinosaur's, the Komodo Dragons. After we will have a late morning dive at to the famous Horse Shoe bay. And continue the day with dives the Cannibal Rock and Tanjung Nusa Kode. A nightdive will be done at the Cannibal Rock.</p>	4
MONDAY	<p>Here you will spend the morning 2 dives, one northeast and one northwest Banta island. After lunch we go to the famous GPS Point. There will be a good chance of seeing Hammerheads.</p>	4
TUESDAY	<p>After breakfast you will make your first dive at the Yellow Wall of Texas. After this dive we cruise to the Alley. This spot is known for it's Manta Rays. The third dive of the day is at The End of the World. Here you have a good chance to see pelagics.</p>	4
WEDNESDAY	<p>Today we leave the Komodo National Park after the third dive, So we leave early in the morning heading for Pillarsteen. The second spot will be Pantai Merah Kecil. Dive number three of the day is at Gili Lawah Laut.</p>	4

After the last dive we will cruise to BIMA port, where we will have a short stopover and then cruise to Satonda.

THURSDAY

On the way to Tulamben we will stop in Satonda to do our last dives. Four more spectacular dives will wait here for you, before we are heading back overnight to Tulamen.

3

FRIDAY

After breakfast you will check out and have a warm welcome in our resort, where you either check-in your room or continue your journey to

 **BALI - KOMODO**

Included in the package are the following services

- Flight from or to Bima
- 7 nights accomodation on board Mermaid I
- all meals during the cruise (fullboard)
- soft drinks free flow during cruise
- bathrobe, towels, soap & shampoo
- all diving and dive related services incl. tanks & weights
- qualified Divemaster or higher (English / German speaking)
- all pick ups and transfer between Airport, Mermaid 1, Tauch Terminal Resort and Hotel
- 5 nights accommodation in superdeluxe room incl. breakfast
- 3 days of non limit diving Tulamben incl. Divemaster or higher
- additional 2 dives at Tulamben Bay
- tanks & weights
- free transfer of gear to divesite

Not included are the following

- Airport tax
- Alcoholic drinks
- Dive gear
- Nitrox
- Dive education or specialties
- Tips

Prices for the whole package

Price for the whole package 12 days – 12 nights Based on Twin or Double cabin / room	US\$ 1995,-
Single surcharge	US\$ 225,-
Price cruise only (6 days – 7 nights)	US\$ 1500,-
Full set of dive gear (cruise only)	US\$ 95,-
Full set of dive gear (cruise & resort)	US\$ 125,-
Extention night Resort (superdeluxe room)	US\$ 80,-
Additional day non limit diving	US\$ 50,-

Schedule 2003

Departure & Arrival always Friday

Cruise #	Start Destination	Day – Departure	Day – Arrival
01	Bali	May, 30 th	June, 06 th
02	Komodo	June, 06 th	June, 13 th
03	Bali	June, 13 th	June, 20 th
04	Komodo	June, 20 th	June, 27 th
05	Bali	June, 27 th	July, 04 th
06	Komodo	July, 04 th	July, 11 th
07	Bali	July, 11 th	July, 18 th
08	Komodo	July, 18 th	July, 25 th
09	Bali	July, 25 th	August, 01 st
10	Komodo	August, 01 st	August, 08 th
11	Bali	August, 08 th	August, 15 th
12	Komodo	August, 15 th	August, 22 nd
13	Bali	August, 22 nd	August, 29 th
14	Komodo	August, 29 th	September, 05 th
15	Bali	September, 05 th	September, 12 th
16	Komodo	September, 12 th	September, 19 th
17	Bali	September, 19 th	September, 26 th
18	Komodo	September, 26 th	October, 03 rd

Lower Deck

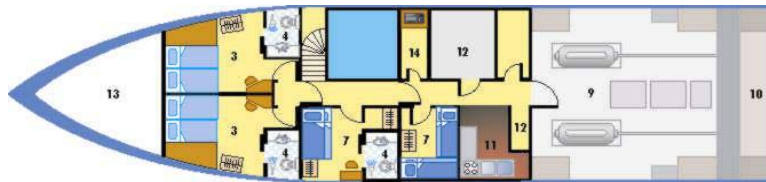

Main Deck

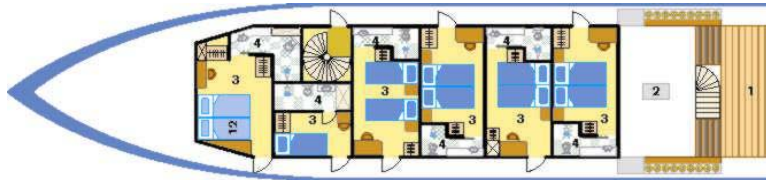

Upper Deck

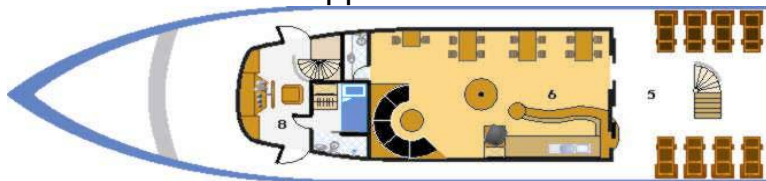

Technical Dates – MV Mermaid I

Steelconstruction with steelgriders

Length : 28 meters
 Wide: 7 meters
 Draught: 2,5 meters

Engine: Volvo Penta 2 x 510 hp
 Max. Speed: 12 knots
 Cruising Speed: 9,5 knots
 Fuel: 18 000 liter

Electricity: 220 V + 12 V
 Generator: Hino 2 x 50kw + 12 Volt,
 Westerbeck supersilence 220 V + 12 V

Compressor: 2 x Bauer 190 l/min
 Nitrox : Mixing panel

Number of guests: 11
 Cabins: 5 double + 1 single all with Aircon + ensuite bathroom

Photolab.: E 6

Salon: 1 with TV, Hifi, Video, A/C

Sundeck: 60 sqm

Freshwater: 20 000 liters

Communications: Radio VHF / SSB, GPS, Radar,
Echolot, Depthmeter, Cellular phone

Emergencygear: Medic First Aid Box, Oxygen 40 000 liter,
DAN Oxygenset, Zodiac 4 m

Divedeck: 6 x 4 meter

Diveplatform: 2,5 x 4 meter

Tanks: 24 x 12 liter , 5 x 15 liter Notrox

Leads: 150 x 1 kg

Boat Crew: 1 Captain, 1 Cook, 1 Engeneer, 2 boatsmen,

Dive Crew: 1 Cruisedirector, 2 Instructor / Divemaster

Some Images



Dive platform



Cabins available with twin or double set up



Ensuite bathroom in each cabin



Restaurant on board



Beachbar at Tauch Terminal Resort



Superdeluxe room Tauch Terminal Resort

Collage " Tauch Terminal Resort Tulamben "



Tauch Terminal Bali
 Headquarter
 Taman Griya
 Jl. Danau Tamblingan X / 40 – 42
 80000 Jimbaran
 Phone ++62-361-730 200
 Fax ++62-361-730 201
www.tauch-terminal.com
smile@tauch-terminal.com